

Kindergarten

610m² integrated day nursery/ kindergarten as a total project

We build schools and kindergartens according to the wishes and needs of our clients in close cooperation with our architect and engineer. We build as a total project from design and development to delivery of a complete building with installations, re-established surroundings and playground.

Competences

We are licensed sewer-plumbing and heating-and electrical engineers with approved quality control and undertake all jobs as turn-key projects. A new undertaking is our sister company ABC Inventar A/S, which produces and delivers furniture and equipment for all purposes.

History

The company has existed since 1999 drawing on the experience of the last 35 years of production of industrial prefabrication for both private and public houses. ABC Pavillon A/S is a member of the Building Trade's Evaluation Centre and the organisation Building Guarantee.

Warranty - Price

We always offer a fixed price on our tasks, just as the different trade groups are subjected to continuous quality control.



Facts

610m² day nursery and kindergarten - as a total project. Starting from site preparation, building to finished institution with re-established surroundings, asphalt road and partially with furniture.

Concept Living A/S^{abc}
ABC Pavillon A/S
Dansk ABC Holding ApS
ABC Jord & Kloak A/S
ABC Inventar A/S
UAB Baltic Modules

” We go all out to help you! ”

 **ABC Pavillon A/S**
Opportunities without limits!



Hilly terrain which is very suitable for playgrounds



40m² arbour for prams with even surface for easy ride



Flat area with some grass which is suitable for day nursery children



Asphalt mooncar track with a shed equipped on a adjusted ground

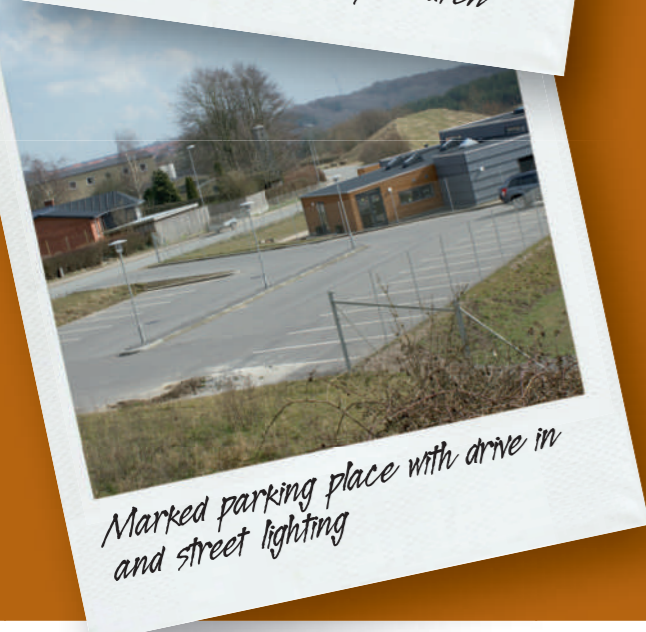

Marked parking place with drive in and street lighting



75m² ventilated group room with an adjacent romping room

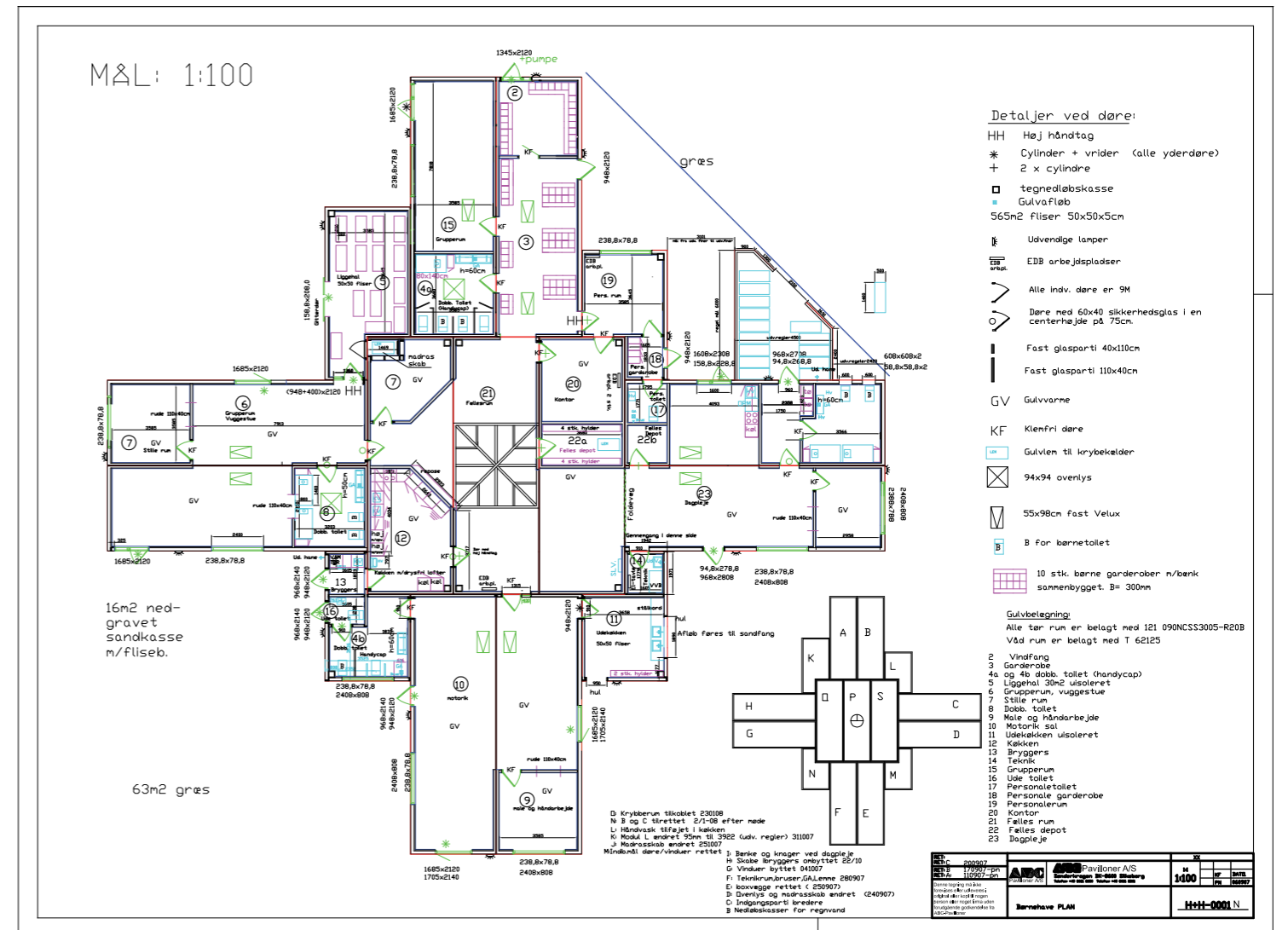

Plandrawing of the institution with great flexibility



Centrally located glass pyramid with power-driven ventilating and curtains



The free standing and hanging wardrobes with bench and drawers